

Date	Group	No.	Page
3.2003	376	01	1(5)

Trailer Cable Routing
VN VERSION 2
from build date 11.2002

Trailer Cable Routing

NOTE: Information is subject to change without notice.

Illustrations are used for reference only and may differ slightly from the actual vehicle being serviced. However, key components addressed in this information are represented as accurately as possible.

Contents:

- "Variant Configuration" page 2
- "Trailer Cable Routing" page 3

Specifications

Variant Configuration

The table below lists the available trailer cable routing variants and their attributes. See "Trailer Cable Routing" page 3 for further information.

Variant	Cable Type	Location	Holder Type
TBCP-FM	Receptacle Mount	Frame	With Pogo Holder (See "Variant: TBCP-FM" page 3)
TEC-FIX	Fixed Mount	Back of Cab	With Slide Holder (See "Variant: TEC-FIX" page 4)
TEC-DET	Receptacle Mount	Back of Cab	With Slide Holder (See "TEC-DET" page 5)

Trailer Cable Routing

The following illustrations detail the trailer cable routing for the VN VERSION2 vehicle.

NOTE: For further electrical information refer to service information in Group 37.

Variant: TBCP-FM

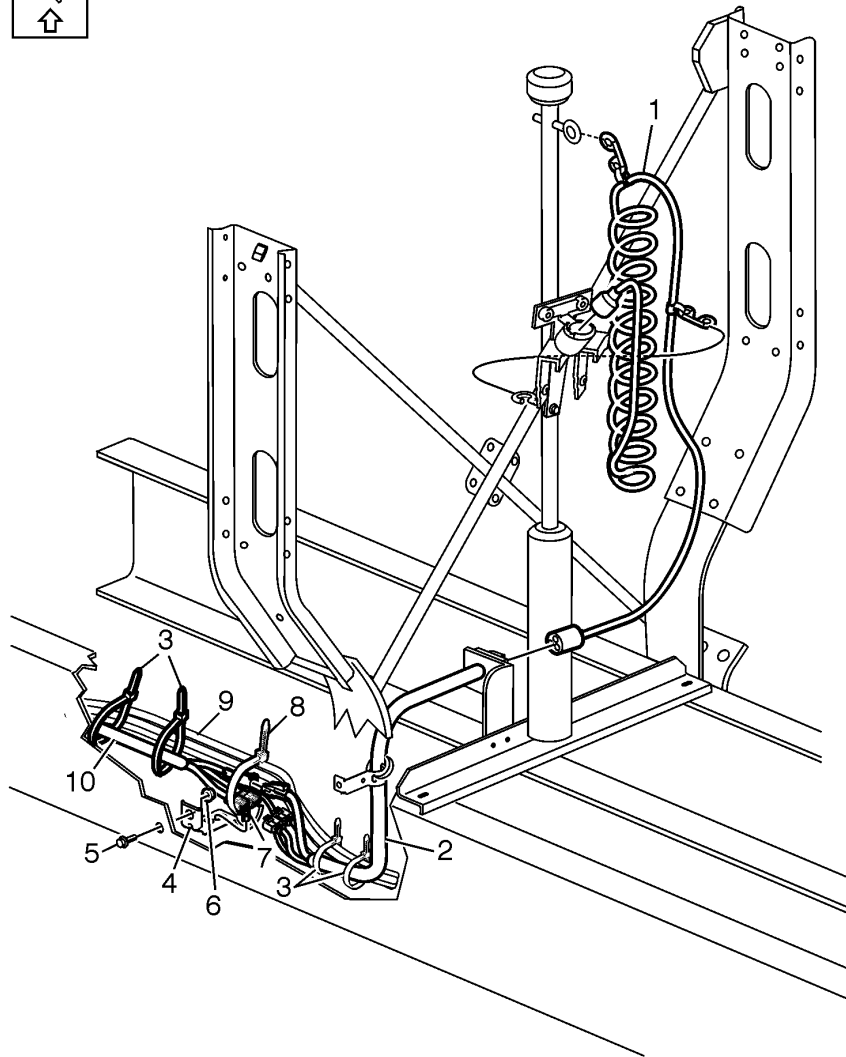
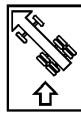

- 1 Wiring Harness (Trailer Cable)
- 2 Wiring Harness
- 3 Cable Tie
- 4 Bracket
- 5 Flange Screw

- 6 Flange Lock Nut
- 7 Retainer (Barbed Type)
- 8 Cable Tie
- 9 Air lines
- 10 Chassis Harness

Variant: TEC-FIX

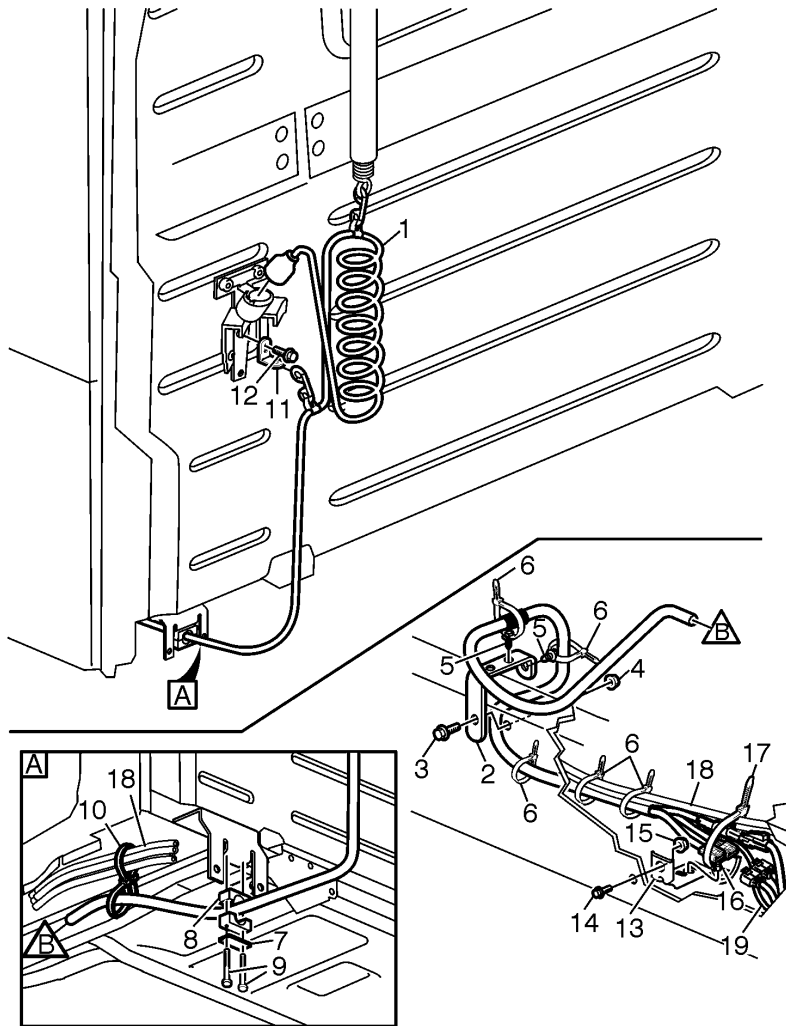
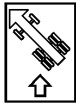

- | | | | |
|---|--------------------------------|----|------------------------------|
| 1 | Wiring Harness (Trailer Cable) | 10 | Cable Tie (Double Head Type) |
| 2 | Bracket | 11 | Bracket |
| 3 | Flange Screw | 12 | *Use Existing Hardware |
| 4 | Flange Nut | 13 | Bracket |
| 5 | Retainer (Barbed Type) | 14 | Flange Screw |
| 6 | Cable Tie | 15 | Flange Lock Nut |
| 7 | Plate | 16 | Retainer (Barbed Type) |
| 8 | Clamp | 17 | Cable Tie |
| 9 | Flange Screw | 18 | Air lines |
| | | 19 | Chassis Harness |

TEC-DET

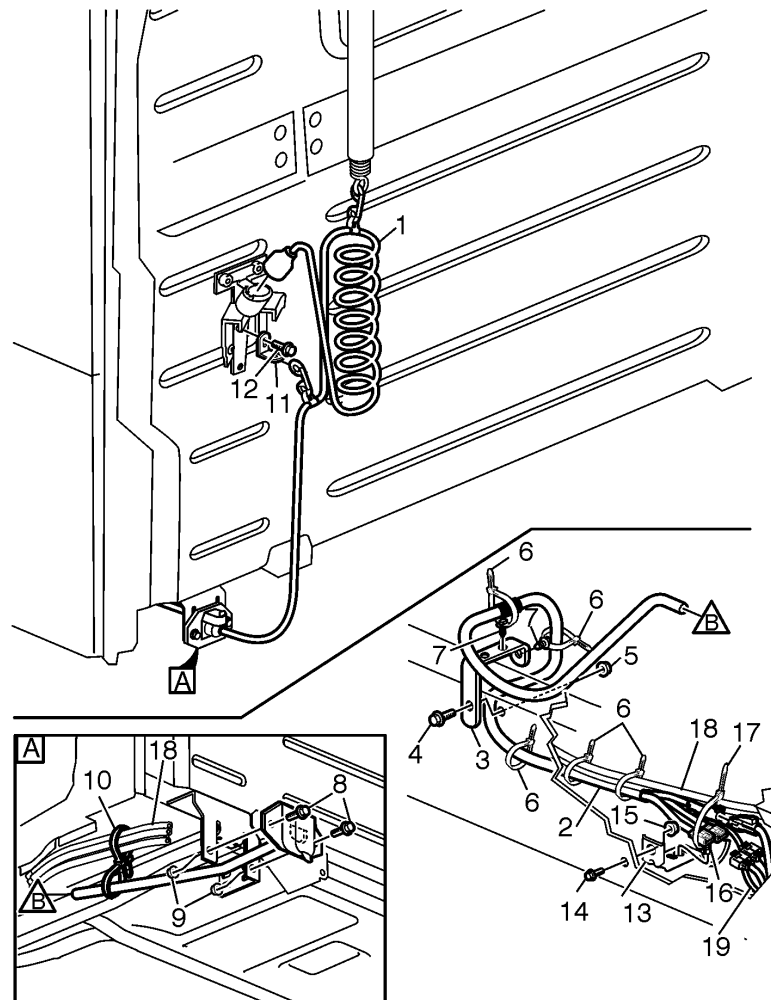
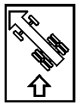

- | | | | |
|----|--------------------------------|----|------------------------|
| 1 | Wiring Harness (Trailer Cable) | 11 | Bracket |
| 2 | Wiring Harness | 12 | *Use Existing Hardware |
| 3 | Bracket | 13 | Bracket |
| 4 | Flange Screw | 14 | Flange Screw |
| 5 | Flange Nut | 15 | Flange Lock Nut |
| 6 | Cable Tie | 16 | Retainer (Barbed Type) |
| 7 | Retainer (Barbed Type) | 17 | Cable Tie |
| 8 | Flange Screw | 18 | Air Lines |
| 9 | Flange Lock Nut | 19 | Chassis Harness |
| 10 | Cable Tie (Double Head Type) | | |