

Date	Group	No.	Page
3.2007	223	127	1(6)

Oil Filter Overflow Valve Replacement D16F

Oil Filter Overflow Valve Replacement

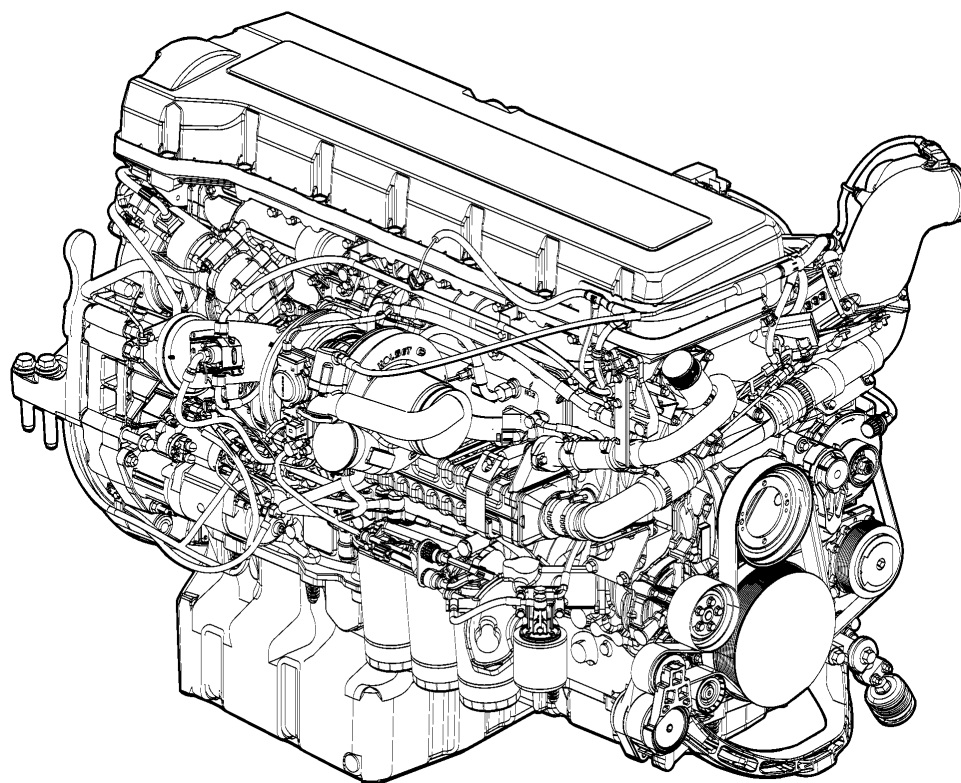

W2005772

This information covers the proper procedures for servicing the overflow valve for the oil filter on the Volvo D16F engine.

Contents

- "Overflow Valve Oil Filter, Full Flow, Replacement" page 2

Note: Information is subject to change without notice. Illustrations are used for reference only, and may differ slightly from the actual engine version. However, key components addressed in this information are represented as accurately as possible.

2239-03-02-03 Overflow Valve Oil Filter, Full Flow, Replacement

You must read and understand the precautions and guidelines in Service Information, group 20, "General Safety Practices, Engine" before performing this procedure. If you are not properly trained and certified in this procedure, ask your supervisor for training before you perform it.

Removal

- 1**
Apply the parking brake and place the shift lever in neutral.
- 2**
Remove the chassis components as required for access to the oil filter overflow valve.
- 3**
Clean the area around the filter overflow valves on the oil filter housing.
- 4**
Remove the screws securing the oil filter overflow valve covers to the oil filter housing. Remove the valves and valve covers from the oil filter housing.

Note: Overflow valves are color-coded depending on whether they are oil pressure reduction valves or safety valves. The reduction valve has a blue-colored mark, while the safety valve has a purple-colored mark. The replacement valve must match the color of the original valve.

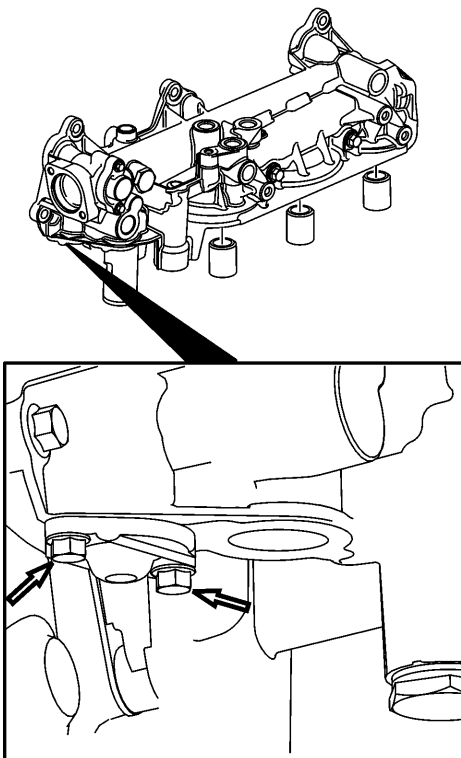

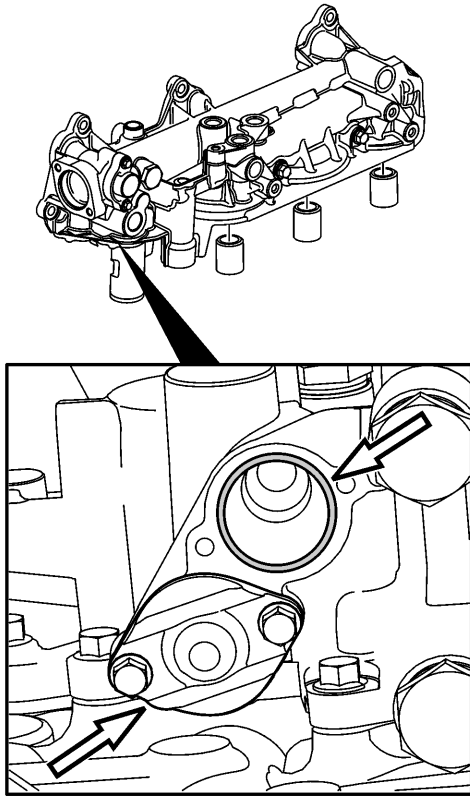

W2004939

5
Remove the O-rings surrounding the valve bore openings and inspect the bores for pitting, abrasions or scoring. Replace the filter housing if any of these conditions are severe.

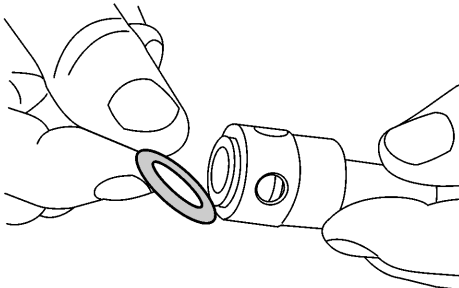

W2004938

6
Remove the square-cut seal from the end of the valve if the valve is not being replaced.

Installation

1

Install a new square-cut seal onto the overflow valve and insert the valve into the filter housing bore.

Note: Overflow valves are color-coded depending on whether they are oil pressure reduction valves or safety valves. The reduction valve has a blue-colored mark, while the safety valve has a purple-colored mark. The replacement valve must match the color of the original valve.

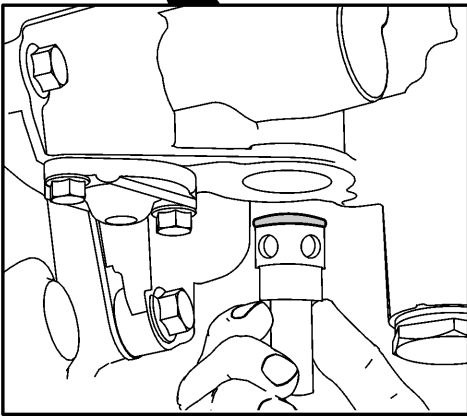
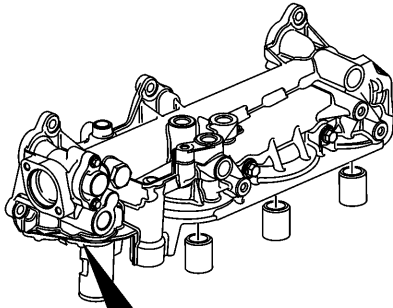

W2004940

- 2**
Place a new seal on the oil filter housing in the groove around the filter overflow valve bore.

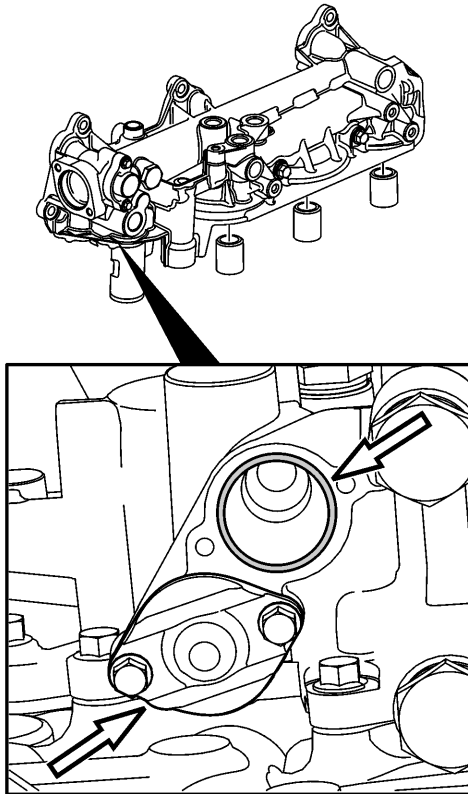

W2004939

- 3**
Install the overflow valve covers onto the oil filter housing and secure the covers with the screws. Tighten the mounting screws to 10 ± 5 Nm (7.4 ± 1 ft-lb).

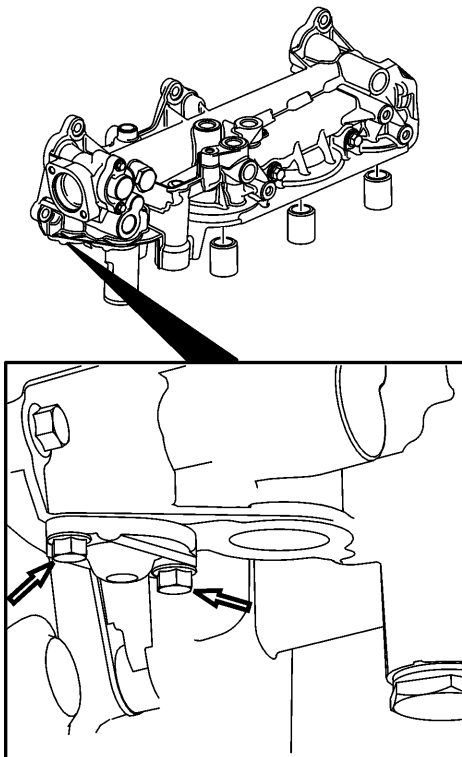

W2004937

4

Install the chassis components as required.

5

Start the engine, check for leaks and proper operation.
After shutdown, replenish fluids as necessary.