

| Date | Group | No. | Page |
|--------|------------|-----------|------|
| 2.2007 | 233 | 59 | 1(9) |

Fuel Filter Housing Replacement D16F

Fuel Filter Housing, Replacement

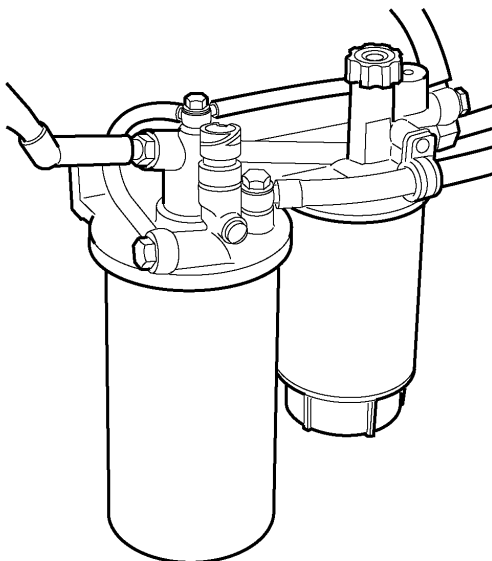

W2005849

This information covers the procedure for replacement of the fuel filter housing on the Volvo D16F engine.

Contents

- "Fuel Filter Housing, Replacement" page 2

Note: Information is subject to change without notice. Illustrations are used for reference only, and can differ slightly from the actual engine version. However, key components addressed in this information are represented as accurately as possible.

Service Procedures

2334-03-02-03

Fuel Filter Housing, Replacement

You must read and understand the precautions and guidelines in Service Information, group 20, "General Safety Practices, Engine" before performing this procedure. If you are not properly trained and certified in this procedure, ask your supervisor for training before you perform it.

Removal

Note: Ignition key must be in the OFF position. Use an approved container to catch fuel from fuel lines and fuel filters as they are disconnected or removed.

1

Apply the parking brake and place the shift lever in neutral.

2

Place an approved container under the fuel filter housing, then drain the water from the primary fuel filter. Disconnect the electrical connector for the water/fuel separator indicator cover.

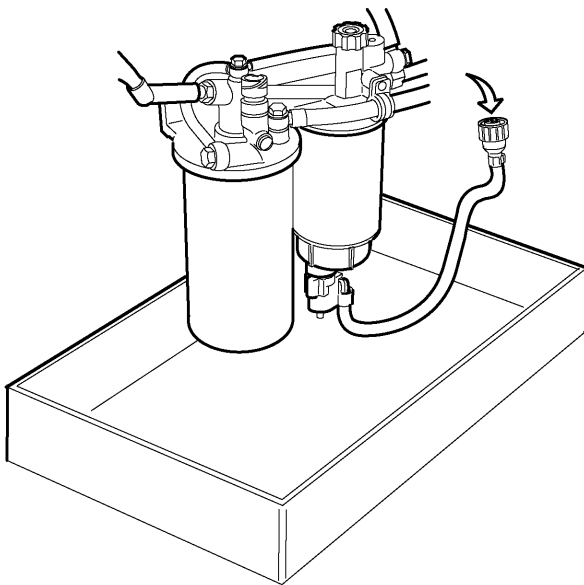

- 3**
Remove the fuel lines above the secondary fuel filter from the fuel filter housing.

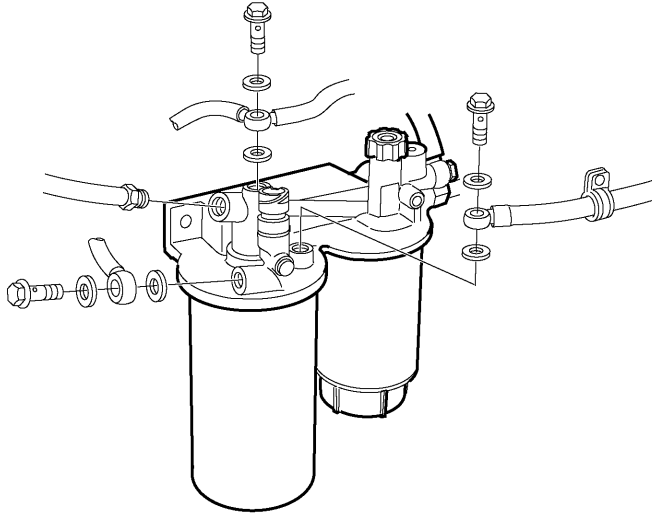

W2005859

- 4**
Remove the remaining fuel lines from the fuel filter housing.

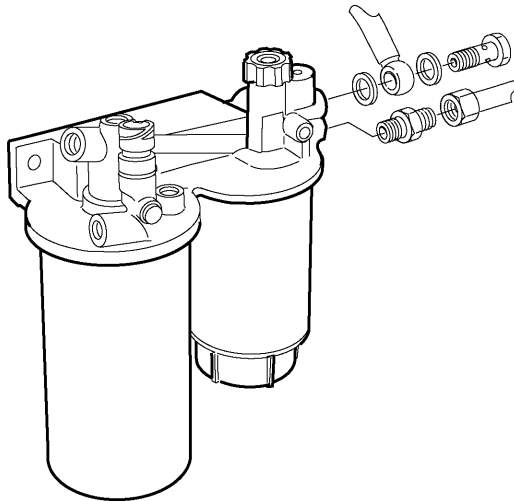

W2005860

- 5**
Remove the fuel filters and water/fuel separator indicator cover from the fuel filter housing.

- 6**
Remove the water/fuel separator indicator cover from the primary fuel filter.

- 7**
Disconnect the electrical connector for the sensor.

- 8**
Remove the bolts and the fuel filter housing.

Note: Install new fuel filters when replacing the fuel filter housing.

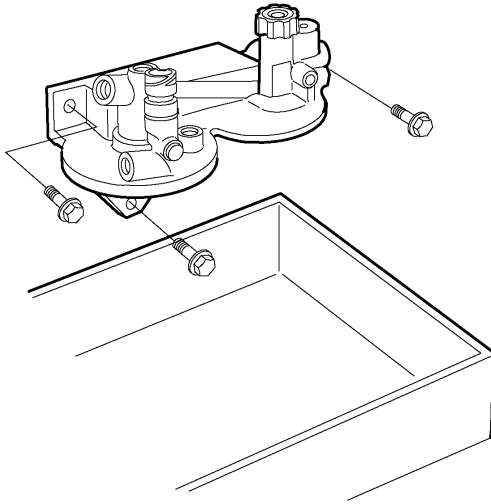

W2005861

Installation

- 1**
Install the bolts and the new filter housing to the side of the engine and tighten the bolts to 24 ± 3 Nm (18 ± 2 ft-lb).
- 2**
Connect the electrical connector for the sensor.

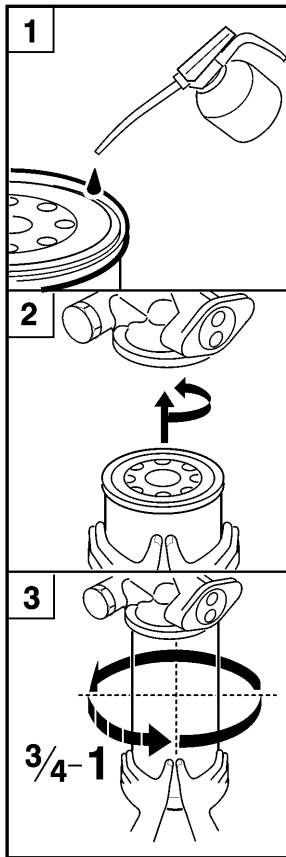

T2021439

3
Apply a thin coating of clean engine oil to the gasket of the secondary fuel filter. Screw the fuel filter into position and tighten $\frac{3}{4}$ to 1 full turn after the gasket makes contact with the fuel filter housing.

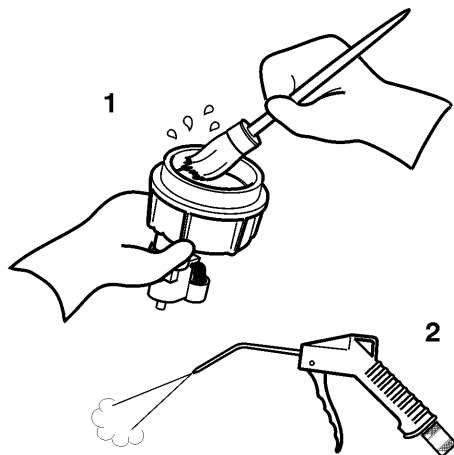

T2021429

4
Remove and discard the old gasket from the water/fuel separator indicator cover. Clean thoroughly. Then blow dry with filtered compressed air.

- 5**
Check that the drainage hole in the lower part is not blocked.

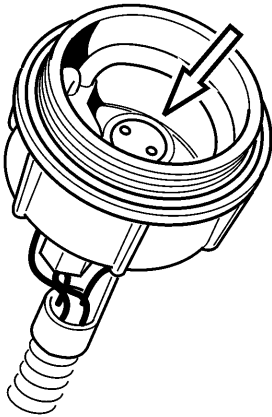

T2021430

- 6**
Apply a thin coating of clean engine oil to the surface of the water/fuel separator indicator cover.

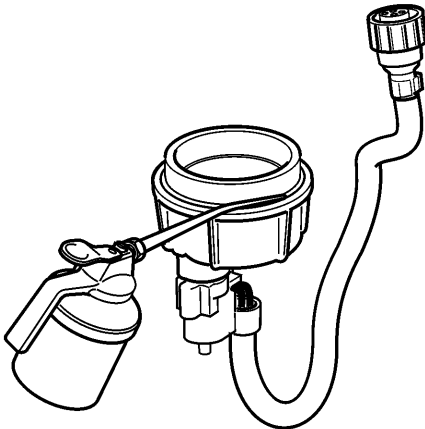

T2021432

- 7**
Install a new gasket to the water/fuel separator indicator cover. Install the water/fuel separator indicator cover to the primary fuel filter.

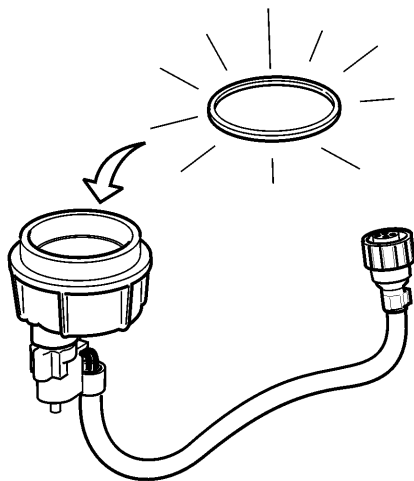

T2021431

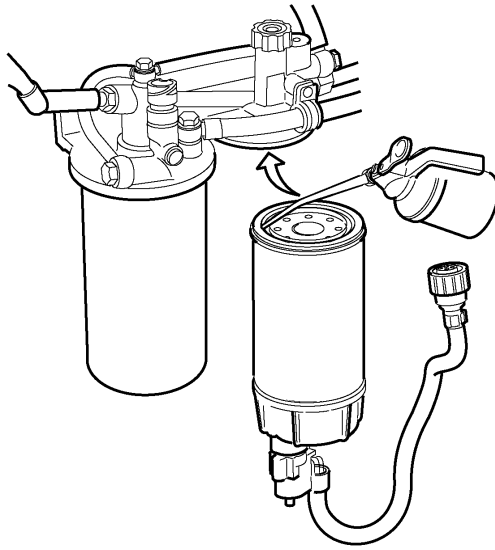

W2005862

8

Apply a thin coating of clean engine oil to the surface of the primary fuel filter, install the fuel filter and tighten 1/2–3/4 turns.

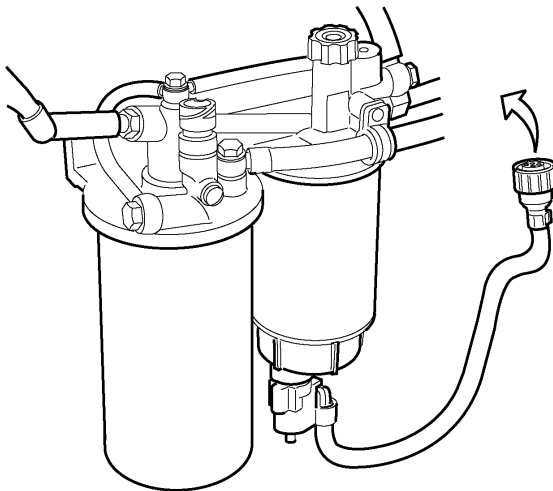

W2005863

9

Connect the water/fuel separator indicator cover electrical connector.

10

Connect the fuel lines and new seals to the primary side of the fuel filter housing.

Note: To avoid leaking fuel lines always use new seals.

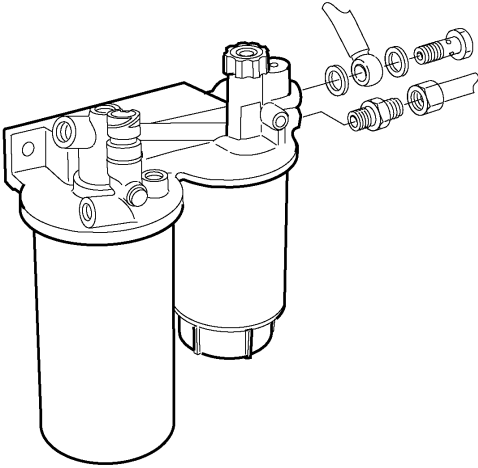

W2005860

11

Install the remaining fuel lines with new seals to the fuel filter housing.

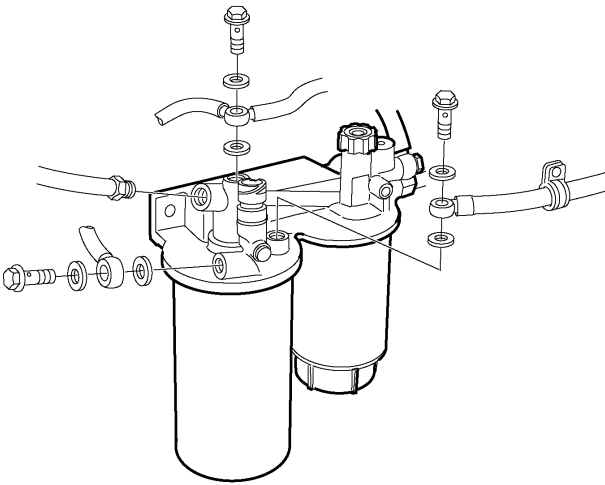

W2005859

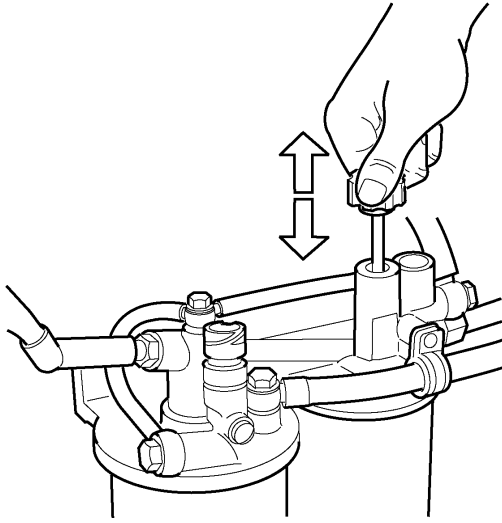

W2005864

12

Prime the fuel system by pumping the hand priming pump on the fuel filter housing until resistance is felt. Resistance indicates that the fuel system is full.

13

Start the engine and run at low idle for about 5 minutes. Check for any fuel leaks and correct if leaks are found.

Note: The engine speed should not be increased above idle. Any air pockets can be forced into the cylinder head and result in the engine stopping.

14

Make sure that there are no fault codes set.