

Date	Group	No.	Page
3.2007	216	46	1(4)

Connecting Rod Bearings, Replace (all)
D16F

Connecting Rod Bearings, Replace (All)

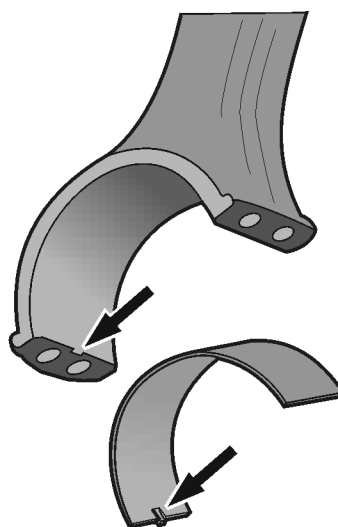

T2019310

Contents

- “Connecting Rod Bearings, Replacement (All)” page 2

Note: Information is subject to change without notice. Illustrations are used for reference only and may differ slightly from the actual vehicle being serviced. However, key components addressed in this information are represented as accurately as possible.

2165-03-03-01 Connecting Rod Bearings, Replacement (All)

Oil pan removed

Special tools: 88800014

1
Remove the plug from the flywheel casing and install engine turning tool 88800014.

88800014

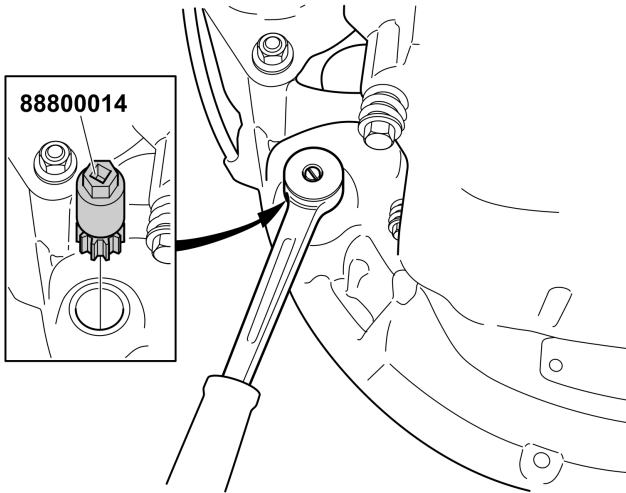

T2022960

2
Remove the pipe and strainer from the reinforcing frame.
Remove the pressure pipe from the pump.
Remove the reinforcement frame.

 WARNING
The reinforcing frame has sharp edges. Use protective gloves to prevent hand injuries.

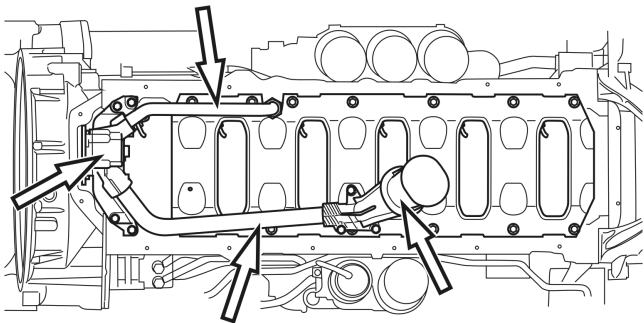

T2023159

3
Turn the flywheel until the bearing caps on connecting rods 1 and 6 are in position for removing the bolts.

88800014

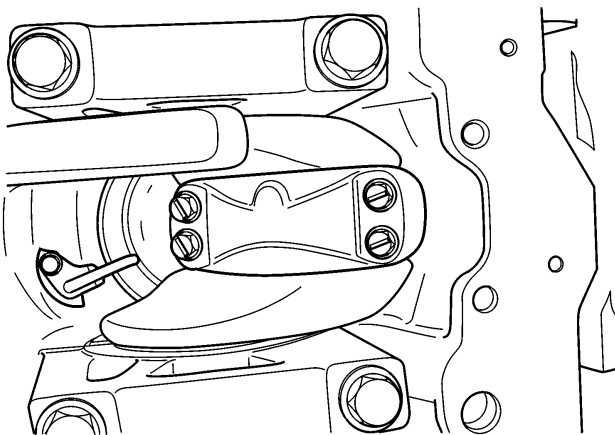

T2022285

4

Remove the piston cooling nozzles to prevent them from being damaged.

5

Remove the caps. Push up the big ends as far as is necessary to remove the bearing shells.

Note: Check the bearing surfaces for uneven wear or other damage. If there is abnormal wear, the cause must be found before reassembly.

Note: Bearing size is found on the back of the bearing shell.

6

Carefully clean the bearing contact on the connecting rods and bearing caps.

Clean the bearing seats and install new bearing shells.

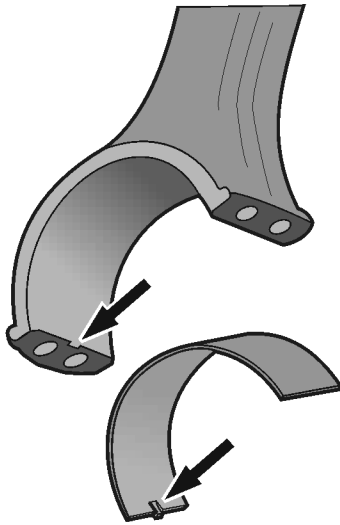

T2019310

7

Lubricate the new bearing shells with clean engine oil.

8

Carefully pull connecting rod (with new bearing) onto the crankshaft. Use caution not to damage crankshaft.

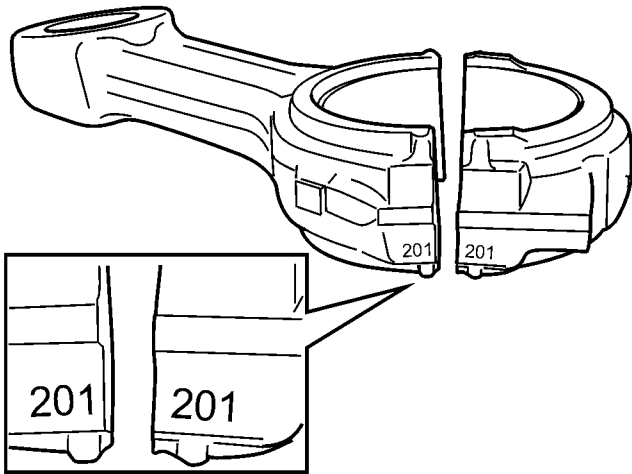

T2019085

9

Install the bearing caps.

Note: Ensure that the correct bearing caps are fitted to the correct connecting rods. Refer to the markings.

Tighten alternately until the surfaces meet. Torque tighten according to "Specifications" Group 20.

10

Install the piston cooling nozzles.

11

Turn the crankshaft until the next pair of connecting rods come into position for removing the bolts. Repeat the above procedure from step **4** through **10**.

88800014

12

Install the reinforcing frame.

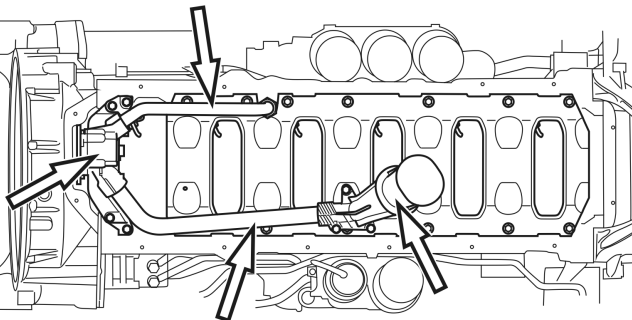

T2023159



WARNING

The reinforcing frame has sharp edges. Use protective gloves to prevent hand injuries.

Torque tighten all reinforcing frame bolts according to the tightening diagram.
Install the pressure pipe with new O-rings. Torque tighten the pipe nut at the engine block.
Install the pipe and strainer on the reinforcement frame with new O-rings. Torque tighten the strainer bolts.
For the correct torque, see "Specifications" Group 20.

Note: Apply thread lock to the strainer bolts.

13

Remove the engine turning tool and reinstall the plug in the flywheel casing.