

Service Manual Trucks

Group **88**

Sink
VN770

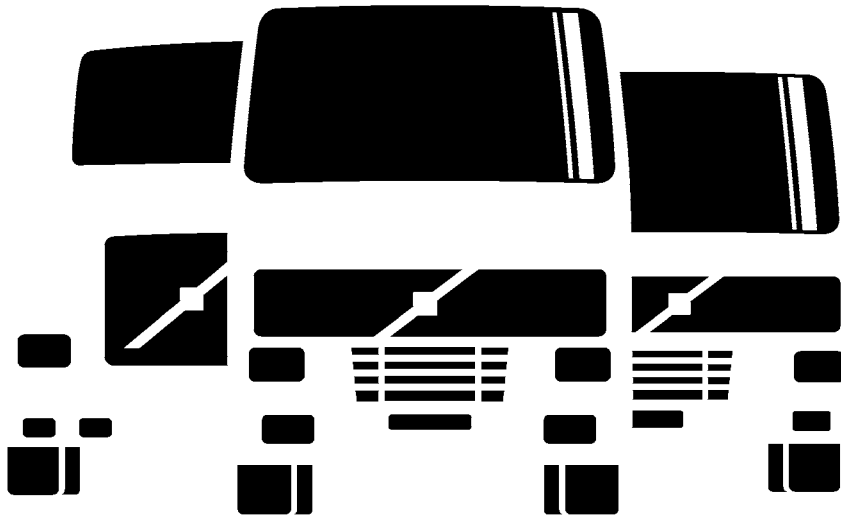

Foreword

The descriptions and service procedures contained in this manual are based on designs and methods studies carried out up to February 00.

The products are under continuous development. Vehicles and components produced after the above date may therefore have different specifications and repair methods. When this is believed to have a significant bearing on this manual, supplementary service bulletins will be issued to cover the changes.

The new edition of this manual will update the changes.

In service procedures where the title incorporates an operation number, this is a reference to an S.R.T. (Standard Repair Time).

Service procedures which do not include an operation number in the title are for general information and no reference is made to an S.R.T.

The following levels of observations, cautions and warnings are used in this Service Documentation:

Note: Indicates a procedure, practice, or condition that must be followed in order to have the vehicle or component function in the manner intended.

Caution: Indicates an unsafe practice where damage to the product could occur.

Warning: Indicates an unsafe practice where personal injury or severe damage to the product could occur.

Danger: Indicates an unsafe practice where serious personal injury or death could occur.

Volvo Trucks North America, Inc.
Greensboro, NC USA

Order number: PV776-TSP137326

© 2000 Volvo Trucks North America, Inc., Greensboro, NC USA

All rights reserved. No part of this publication may be reproduced, stored in retrieval system, or transmitted in any forms by any means, electronic, mechanical, photocopying, recording or otherwise, without the prior written permission of Volvo Trucks North America, Inc..

Contents

General	3
Sink	3
Troubleshooting	5
Sink Assembly, Simplified Schematic	5
Sink Pump Assembly, Troubleshooting	7
Service Procedures	9
Sink Drain Assembly, Replacement	9
Sink Bowl, Replacement	10
Sink Faucet, Replacement	11
Sink Pump, Replacement	12
Strainer, Cleaning	12

General

Sink

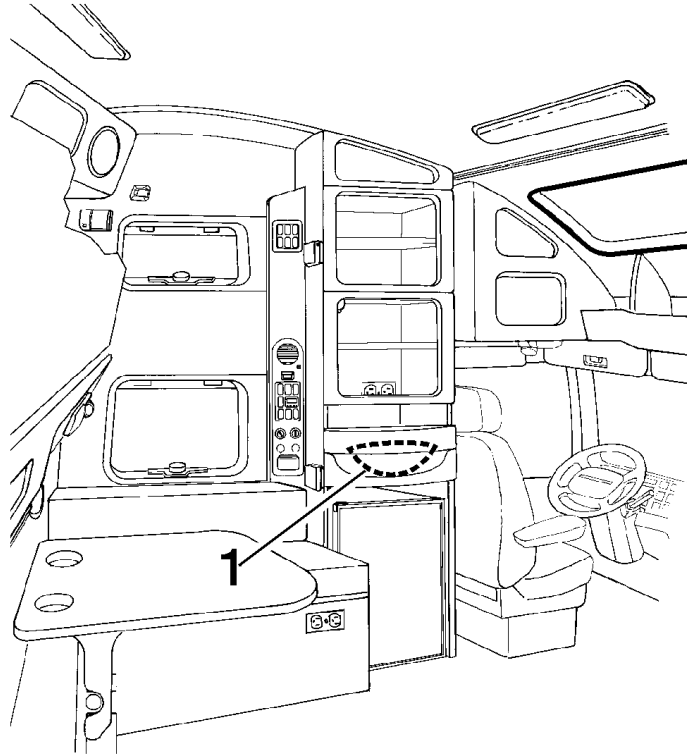

W8002581

This Manual contains "Troubleshooting" page 5 and "Service Procedures" page 9 about the Sink (1) that can be mounted as an option in the VN770. It is located on the left side, in the cabinet behind the driver.

The sink is mounted in the drawer space. To pull out, grasp the drawer lip and release the latch.

Troubleshooting

Sink Assembly, Simplified Schematic

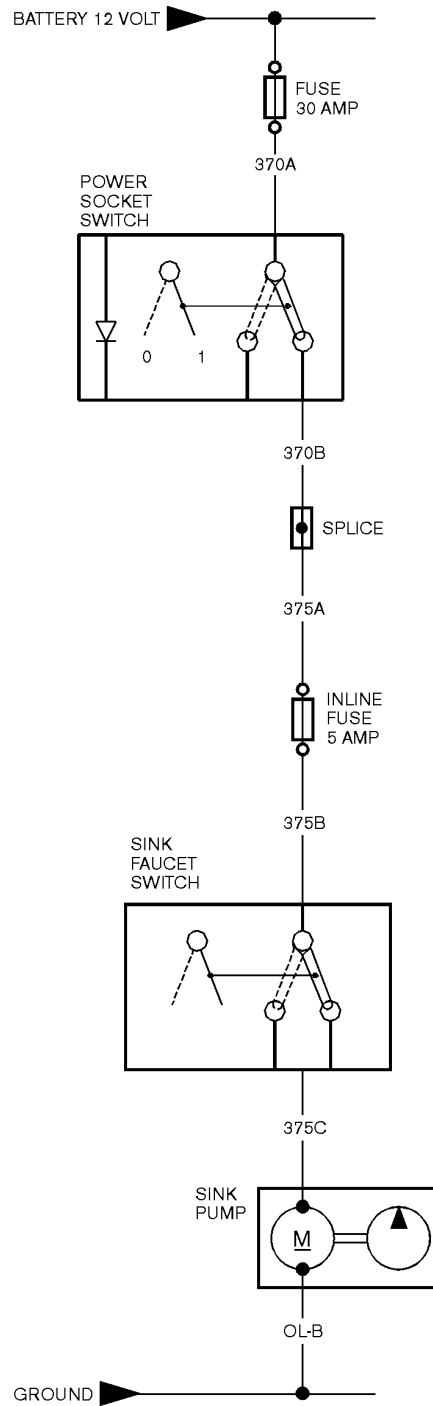

For a detailed schematic see:

Electrical Schematic IMPACT PV776-370-98110/2
Sink and Pump, VN770
 Function Group 370
 Information Type: Schematics
 Sink and Pump

Sink Pump Assembly, Troubleshooting



Before working on a vehicle, set the parking brakes, place the transmission in neutral and block the wheels. Failure to do so can result in unexpected vehicle movement and can cause serious personal injury or death.



Never run the pump dry. Drain the pump and the lines in freezing conditions. Failure to do so can result in damage to the pump.

Note: The power socket switch in the bunk must be ON for pump operation.

See Fig. 1: Sink Assembly, page 9 for troubleshooting reference

Symptom: Pump will not run	
Possible cause	Corrective action
Fuse blown:	The fuse for the pump is under the sink assembly. The fuse is a 5 A in-line fuse. Replace and test.
No power supply:	At the fuse, check for 12 volts. If not, check power supply from the power socket switch in the control panel.
Faucet switch bad:	Disconnect the switch on the faucet. Connect an ohmmeter to the switch terminal leads. With the switch OFF, there should be no continuity. With the switch ON, there should be continuity. If not, replace the faucet assembly.
Pump bad:	Disconnect wiring at the pump. Connect a voltmeter to the wiring terminal ends. With the switch ON, there should be 12 volts at the wiring terminal connection. If not, check the pump's wiring and the switches. If 12 volts is present, check wiring between connector and pump. If no fault is found, replace the pump.

Symptom: Pump runs but no water will flow	
Possible cause	Corrective action
Empty fresh water tank:	Fill and re-test.
Pump mounted more than 4 inches above water level:	The pump will self prime a maximum of 4 inches above water level. Check the pump mounting height. The pump mounting holes should be approximately 4 inches above the luggage compartment floor mat.
Pump plumbed incorrectly:	Confirm that inlet and outlet are connected correctly. Arrows on the pump fittings show the flow direction.
Pump inlet hose loose:	Tighten the hose to prevent the pump from taking in air.
Hose kinked or obstructed:	Check the hoses. Correct as needed.
Fresh tank vent closed:	Fresh water tank is equipped with a water fill hose assembly. The hose assembly is stored on the vent elbow on top of the fresh water tank. The ON/OFF valve on the hose assembly must be in the ON position to prevent a vacuum lock on the tank.
Pump mechanical failure	Replace pump.
Strainer clogged (Available from 01/2000)	Take the strainer apart by rotating it and use a brush or a finger to remove any dirt. If the strainer needs to be cleaned more thoroughly it can be removed by loosening the hose clamps.

Service Procedures

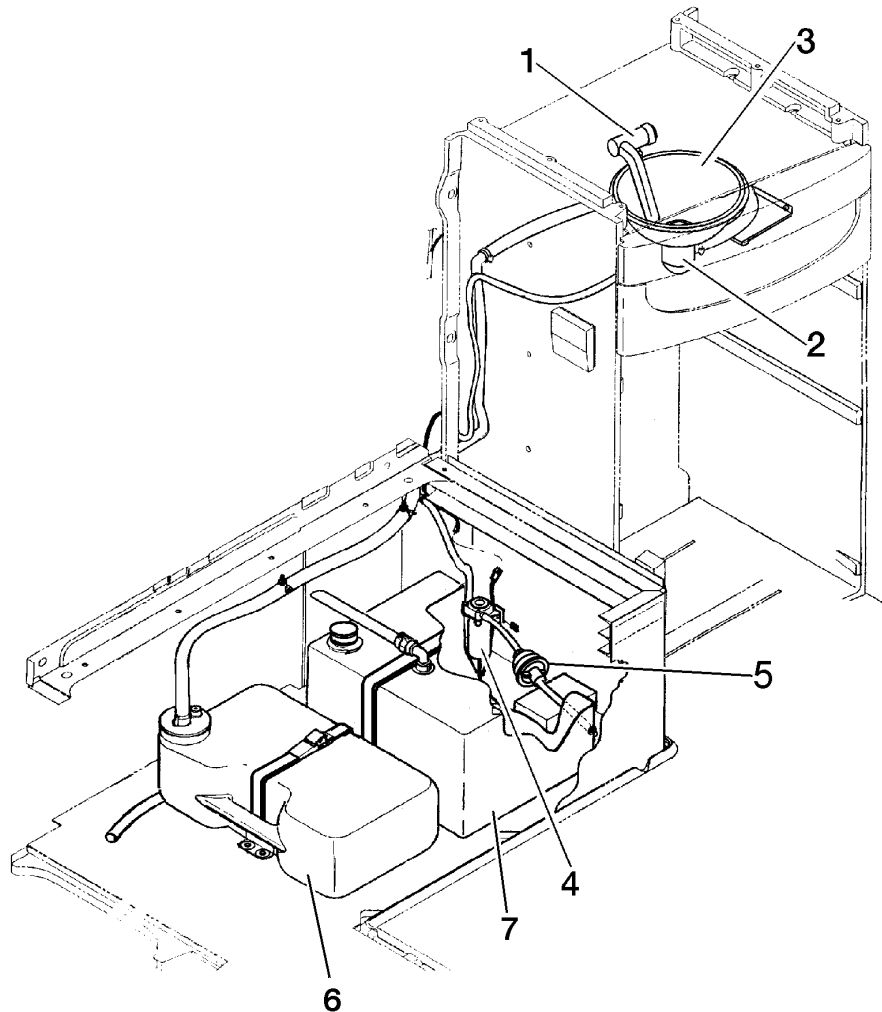

Fig. 1: Sink Assembly

W8002589

- 1 Faucet
- 2 Sink Drain
- 3 Sink Bowl
- 4 Sink Pump

- 5 Strainer (Available from 01/2000)
- 6 Waste Water Tank
- 7 Fresh Water Tank

8851-03-02-03 Sink Drain Assembly, Replacement



DANGER

Before working on a vehicle, set the parking brakes, place the transmission in neutral and block the wheels. Failure to do so can result in unexpected vehicle movement and can cause serious personal injury or death.

Removal

- 1 Pull out the sink drawer until it stops. Lift it over the detents to lock it in the "out" position.
- 2 Remove the drain hose from fitting by loosening the clamp.

See Fig. 1: Sink Assembly, page 9.

3

The upper and lower drain assembly are threaded together. To remove the lower drain assembly, turn by hand to the left (counterclockwise) until the lower drain assembly is removed.

4

Lift out the upper drain assembly.

Installation

1

Position the sealing gasket between the sink bowl and upper drain assembly. Place the upper drain assembly in the sink bowl.

2

Thread the lower drain assembly onto the upper assembly. Tighten so that when the lower assembly is tight, the drain fitting is pointed to the front of the truck.

3

Install the drain line and tighten the clamp.

4

Check the sink drawer for proper operation. There should be no stress on the drain hose when the drawer is opened or closed. Make adjustments if needed.

8851-03-02-02

Sink Bowl, Replacement



DANGER

Before working on a vehicle, set the parking brakes, place the transmission in neutral and block the wheels. Failure to do so can result in unexpected vehicle movement and can cause serious personal injury or death.

See Fig. 1: Sink Assembly, page 9.

Removal

1

Remove the sink drain assembly, see "Sink Drain Assembly, Replacement" page 9.

2

Remove the mounting screws under the sink bowl assembly.

3

Pivot faucet up, clear of bowl. Remove the bowl.

Note: Sealant under the bowl lip may make removal more difficult.

Installation

1

Clean mounting surface on the sink drawer.

2

Invert the sink bowl. Clean mounting lip if necessary. Apply an even bead of "tub and tile" caulk to the lip.

3

Carefully install the sink bowl into the mounting hole. Be sure the mounting tabs on the sink do not interfere with the faucet or the drawer latch assembly.

4

Tighten mounting screws. Clean any excess caulk from the sink bowl counter surface.

5

Install the sink drain assembly, see "Sink Drain Assembly, Replacement" page 9.

8851-03-02-04

Sink Faucet, Replacement



Before working on a vehicle, set the parking brakes, place the transmission in neutral and block the wheels. Failure to do so can result in unexpected vehicle movement and can cause serious personal injury or death.

See Fig. 1: Sink Assembly, page 9.

Removal

1

Pull out the sink drawer until it stops. Lift it over the detents to lock it in the "out" position.

2

Loosen, under the sink drawer, the clamp on the supply hose to the faucet fitting. Pull the hose off the faucet fitting.

3

Disconnect the terminal from faucet assembly wire.

4

Remove the mounting nut under the faucet assembly.

5

Tilt the faucet assembly forward and remove the faucet together with the wiring from the mounting hole.

Installation

1

Position the gasket on the bottom of the faucet assembly and position the faucet wiring in the slot on the faucet mounting stud.

Thread the wiring through the mounting hole. Position the mounting stud and the faucet in the mounting hole.

2

Thread the wiring through the mounting nut and install the nut on the mounting stud.

Hold the faucet assembly with faucet positioned over the sink and tighten the mounting nut.

3

Install the water supply hose and tighten the clamp.

Position the elbow, on the bottom of the faucet, and the supply hose to insure smooth operation of the sink drawer without binding the drawer or kinking the hose.

4

Connect the wiring from the faucet to cab wiring harness. Secure with tie straps as necessary.

5

Check the sink drawer for proper operation. There should be no stress on supply line or wiring. The faucet should be positioned so that the drawer will fold faucet into bowl when drawer is closed.

Make adjustments if needed.

8851-03-02-05 Sink Pump, Replacement



Before working on a vehicle, set the parking brakes, place the transmission in neutral and block the wheels. Failure to do so can result in unexpected vehicle movement and can cause serious personal injury or death.

See Fig. 1: Sink Assembly, page 9.

Removal

1
Access the sink pump through left luggage compartment door. Loosen the straps on fresh and waste water tanks, move them to the side to gain access to the pump.

Note: It may be necessary to drain the tanks.

2
Disconnect the pump wiring connector. Loosen the hose clamps and remove inlet and outlet hoses.

3
Remove 2 mounting screws and remove the pump.

Note: On early models, it may be necessary to remove the left tower cabinet to remove the pump mounting bolts. If so, see Service Manual "Cab Upholstery" Group 85, "Headliner Replacement, Bunk VN770".

Installation

1
Install an insulating strip on the pump mounts. Use the mounting screws to perforate the strip through the mounting holes.

2
With the pump, insulating strip and mounting screws together as an assembly, mount the pump and tighten the mounting screws.

Note: Orient the pump so inlet and outlet hoses will connect correctly.

3
Install inlet and outlet hoses. Secure the clamps. Connect the electrical connections.

4
Reposition and secure the fresh and waste water tanks. Secure the sink drain hose to the waste water tank.

5
Fill up the fresh water tank and test pump operation. Check for leaks.

Note: The pump should never be operated dry. The pump, tank and lines should be drained if freezing temperatures are encountered.

Strainer, Cleaning

See Fig. 1: Sink Assembly, page 9.

In sink assemblies installed 01.00 or later a strainer filters the water from the fresh water tank to the pump.

Periodically this strainer needs to be checked for debris and cleaned if necessary. Rotate the strainer to take it apart. Remove any debris or dirt with a finger or by using a brush.

VOLVO

Volvo Trucks North America, Inc.

P.O. Box 26115, Greensboro, NC 27402-6115

Volvo Trucks Canada, Ltd.

6490 Vipond Drive, Mississauga, Ontario L5T 1W8

<http://www.volvotrucks.volvo.com>